

Disc brake RST 1

dimensions and technical data

edition 06/2022 | EN
page 1 / 1

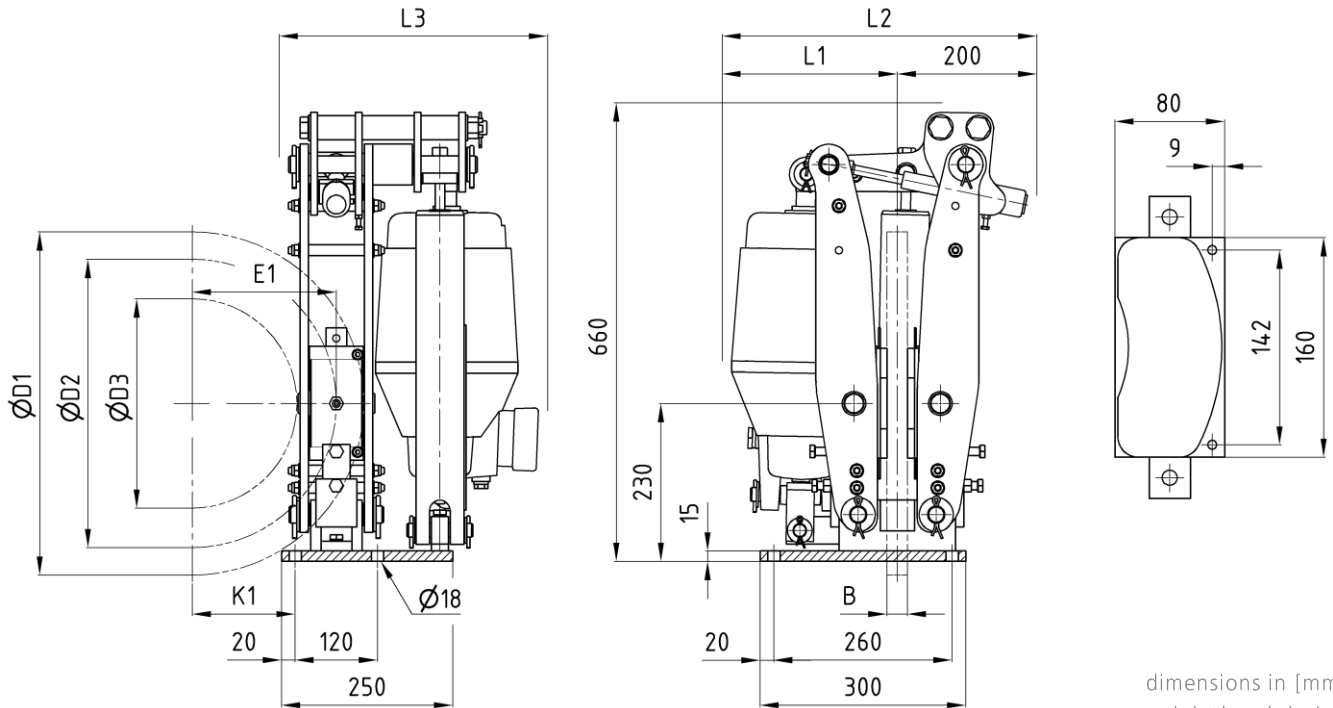

dimensions in [mm]
right hand design

Order example: RST 1 50/6 – D1 x B

left hand design laterally reversed at brake disc

Technical data

Estimated weight 60 kg ²⁾				Thruster size							
				23/5		30/5		50/6		80/6	
Brake disc dimensions [mm]				M _B [Nm] μ = 0,4 ¹⁾							
ØD1	ØD2	ØD3	K1	min	max	min	max	min	max	min	max
315	237	120	58	90	320	110	430	190	740	290	1150
355	277	160	78	100	365	130	500	220	850	350	1380
400	322	205	100	110	410	150	590	260	1000	410	1650
450	372	255	125	120	455	170	680	300	1200	470	1900
500	422	305	150	140	510	190	750	340	1350	520	2100
560	482	365	180	160	570	210	840	380	1500	570	2300
630	552	435	215	180	670	230	950	420	1700	650	2600
L1 = 260 L2 = 460 L3 = 380								L1 = 300 L2 = 500 L3 = 380			

Brake disc diameter ØD1	max. 630 mm
Friction diameter ØD2	D1 - 78 mm
Maximum hub diameter ØD4	D1 - 195 mm
Thickness brake disc B	min. 20 mm
Center brake disc / brake pad E1	K1 + 60

- Available with sensor for monitoring brake open / closed position
- Available with sensor for monitoring brake pad wear
- Available in low temperature or high temperature version
- Available with brake cover made from aluminium or stainless steel

1) Friction value can change due to various operation conditions like circumferential speed, contact pressure, thermal load, material of the brake disc and environmental influences. This should be taken in consideration when calculating the brake.
2) without thruster, without accessories